



California Faucets®

Descanso™

2 HANDLE TUB OR SHOWER TRIM

Features

- Solid brass construction
- Less head, arm, flange, and spout
- Requires rough-in (2-VR) sold separately
- Over 30 finishes including 15 PVD finishes

**TO-3006L
TO-3006KL
TO-3006FL**



(TO-3006KL SHOWN)

Codes/Standards

Product meets or exceeds the following:

- ASME A112.18.1/CSA B125.1
- ADA compliant

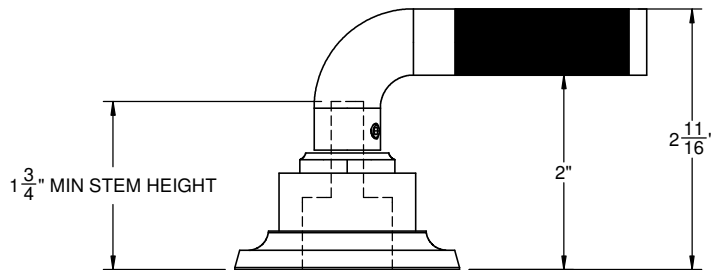
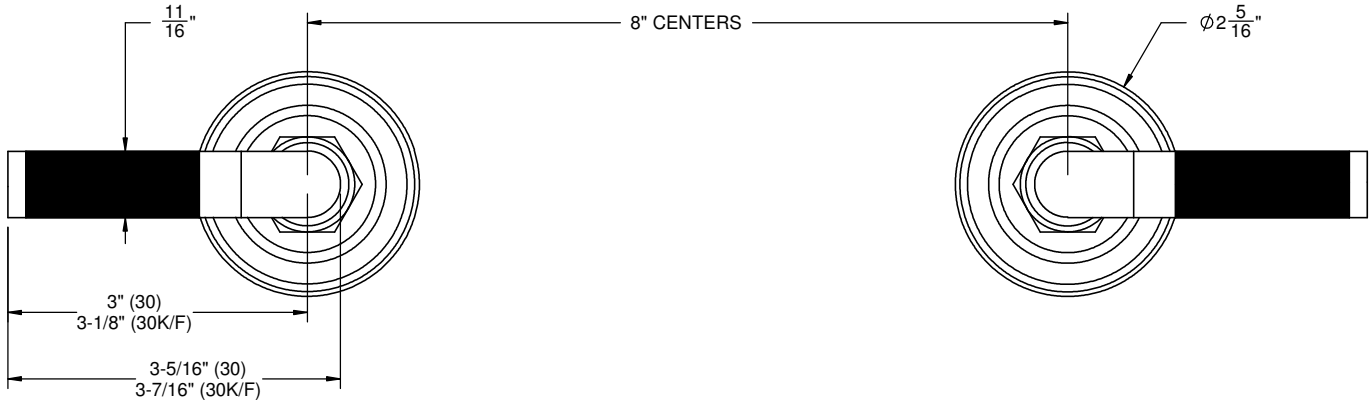

THRU HOLE SPECIFICATIONS			
	MIN	RECOMMENDED	MAX
VALVE:	$\varnothing 1 \frac{1}{8}$ "	$\varnothing 1 \frac{3}{8}$ "	$\varnothing 1 \frac{5}{8}$ "